



GEORGINA

April 21, 2025

Notice of safety and active use improvements to Lake Drive East Lake Drive Improvements - Phase 1

In the coming months, the first phase of the Lake Drive Improvements project will transform how we safely enjoy this popular stretch of road. This summer, you'll notice changes as the Town implements a new seasonal multi-use pathway on Lake Drive East from Civic Centre Road to South Drive. Vehicles will travel one-way eastbound along this same length of Lake Drive East. These changes will greatly enhance safety for all using this route during the summer months – the busiest time of the year along Lake Drive.



What can you expect?

- Starting in May 2025, construction crews will begin working on installation of traffic calming measures, pavement markings, sign installations and a sidewalk extension.
- Upon construction completion, the north lane will feature a multi-use pathway (MUP) along Lake Simcoe. The south lane will be a one-way eastbound vehicular lane.
- The improvements are planned to be implemented prior to June 27, 2025.
- This configuration is seasonal and the MUP/one-way arrangement will be removed by Oct. 3, 2025, and re-installed in spring 2026.
- Emergency services, waste pickup, school buses and Canada Post will adjust their routes to continue providing services.
- Additional communications will be rolled out in the coming weeks.

Make the most of the new Lake Drive!

- Use Lake Drive as the scenic and recreational jewel that it is. It's a great place to slow down a little.
- To save time, use Metro Road as a quicker alternative to Lake Drive.
- Share the road. Pay attention, be careful and respectful of others using Lake Drive at all times.

[georgina.ca/LakeDrPhase1](https://www.georgina.ca/LakeDrPhase1)

- Observe and obey all traffic and parking restrictions on Lake Drive and the surrounding streets. Restrictions will be enforced.
- Remember to avoid turning west at Lake Drive and Dalton Road. Travel west along Metro Road instead.
- Do not use South Drive or Hardwood Drive to access Lake Drive from Metro Road. These streets are now closed to northbound through traffic.
- Do not drive through, park at or block designated “Emergency Access Only” entrances. These restrictions will be enforced.
- Look for new traffic calming features including: pedestrian crossings and speed humps, all-way stop intersections, speed reducing bollards, and an automated speed enforcement camera. Refer to the schematic below for locations of these features.

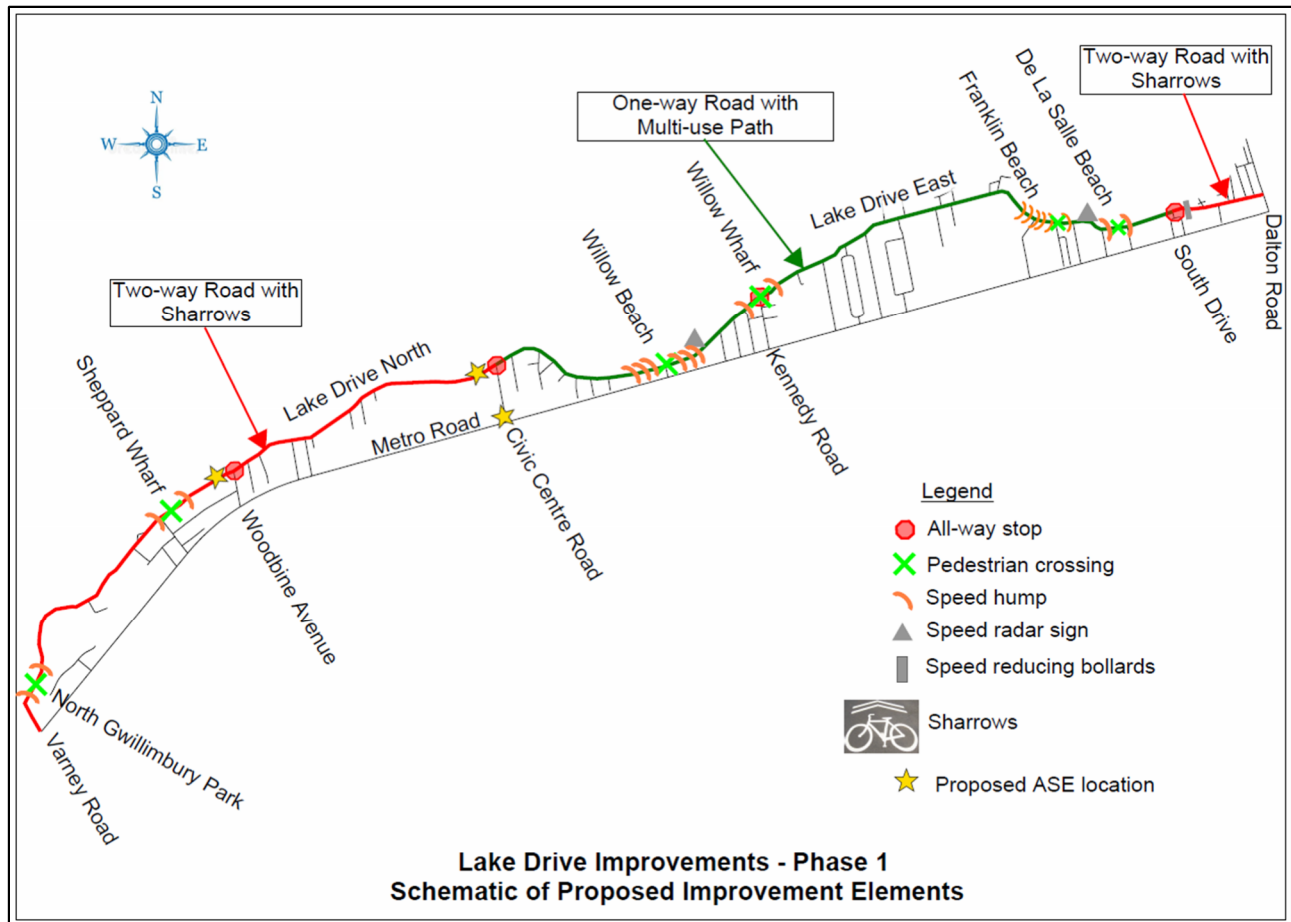

Thank you for your patience while we complete this important construction project. If you have questions about the upcoming work, contact below or visit georgina.ca/LakeDrPhase1

Town of Georgina

Owen Sanders, Senior Project Manager, Operations and Infrastructure

osanders@georgina.ca

905-476-4305, ext. 2902